



PUBLIC BUILDING COMMISSION of Chicago

Brandon Johnson

Mayor

Ray Giderof

Acting Executive Director



HOUSEKEEPING ITEMS

While we wait...

Please **MUTE** your computers and/or cellphones

- Press *6 to unmute (if asked to speak)

Please **CHANGE** your screen name

- Use 'Your Name (Company Name (or Initials))'
EXAMPLE: James Borkman (PBC)

Please **ADD** your name to Chat

- Use 'Your Name|Company Name (or Initials)'
EXAMPLE: James Borkman (PBC)

Please **WAIT** for Q&A to ask questions

- Q&A session will be at the end of each meeting
- Feel free to use the 'Chat' feature





**Works Progress Administration
("WPA") Street Reconstruction
South Central Park Ave. & East 91st St.**

Pre-Bid and Technical Review
Meeting

May 20, 2024 at 10:00am

AGENDA

Introductions

Procurement Details

Compliance

Technical Review

Q&A



Introductions

INTRO

PBC

CDOT & Partners

General Contractors

Sub-Contractors/Suppliers



Procurement Details

PROJECT OVERVIEW

Project Locations

- South Central Park Avenue from 75th Street to 75th Place - (Ward 18)
- East 91st Street from South Woodlawn Avenue to South Avalon Street – (Ward 8)

General Scope of Work

- Full depth pavement reconstruction
- Earth excavation
- Portland Cement concrete base course
- Hot-Mix Asphalt surface course
- Sewer Main and Drainage Structures
- Water Main
- Roadway Lighting
- Concrete Curb, Gutter, ADA Curb Ramps, Sidewalks, Driveway and Alley Aprons
- Pavement markings and signs
- Topsoil, Sodding, and Tree Planting

Procurement Details

PROJECT OVERVIEW

Time of Completion Requirements

Liquidated Damages

- **\$1,00.00 per day** – For failure to achieve Substantial Completion
- **\$500.00 per day** - For failure to achieve milestone date(s)

Time of Completion

Substantial Completion must be achieved no later than November 29, 2024. Schedule Milestones must be completed as follows:

Milestone Descriptions	Milestone Dates
Schedule Milestone #1: Mobilization <ul style="list-style-type: none">• Pre-Construction, including Construction Submittal, Material and Equipment Procurement, Schedule Preparation, Mobilization, Utility Coordination, etc. (Start no sooner than June 28, 2024)	7/31/2024
Substantial Completion <ul style="list-style-type: none">• Full-depth pavement reconstruction of pavement reconstruction of South Central Park Avenue from W.75Th Place to W. 75th Street and East. 91st Street from S. Woodlawn Ave. to S. Avalon Ave. Work includes but isn't limited to Earth excavation, portland cement concrete base course, hot-mix asphalt surface course, water main, sewer and drainage structures, concrete curb and gutter, concrete sidewalks, tactile/detectable warning surface system for curb ramps, concrete driveways and alleys, lighting, thermoplastic pavement marking, signs, topsoil, sodding, and tree planting. (Start no sooner than July 31, 2024)	11/29/2024
Schedule Milestone #2: <ul style="list-style-type: none">• Landscape Planting (Start no sooner than October 1, 2024)	11/29/2024

Procurement Details

AVAILABILITY OF DOCUMENTS

Online Planroom

[Cushing & Company Planroom](#)

Printer Contact Information

Cushing & Company

213 West Institute Place, Suite 200

Chicago, Illinois 60610

Contact Name: Diane Nelson

Telephone Number: (312) 266-8228

BOOK 1	BOOK 2	BOOK 3
<ul style="list-style-type: none">IntroductionGeneral Project DetailsIFB InstructionsSubmission Requirements <p>Highlights:</p> <ul style="list-style-type: none">Bid FormMBE/WBE/EEO GoalsCommunity Area Map	<ul style="list-style-type: none">Standard Terms & Conditions for Contracts	<ul style="list-style-type: none">Technical SpecificationsConstruction Plans (Prepared by EOR)

Procurement Details

Assist Agencies

PUBLIC BUILDING COMMISSION OF CHICAGO'S ASSIST AGENCIES

Assist Agencies are comprised of Chamber of Commerce and Not-for-Profit agencies that represent the interests of small, minority- and/or women-owned businesses. If your agency would like to be added to the PBC's Assist Agencies list, please send an email to patricia.montenegro@cityofchicago.org.

African American Contractors Association
PO Box #19670
Chicago, IL 60619
Omar Shareef
312-915-5960
aacanatlassoc@gmail.com
www.aacanatl.org

Black Contractors United
12000 S Marshfield Ave
Calumet Park, IL 60827
Carole Williams
708-389-5730
bcunewera@att.net
blackcontractorsunited.com

CANDO Corporation
1633 S Michigan Ave
Chicago, IL 60615
LaVerne Hall
(312) 488-9338
LHall@candocorp.net

Chatham Business Association: Small Business Development, Inc.
800 E 78th St
Chicago, IL 60619
Melinda Kelly
(773) 994-5006
melindakelly@cbaworks.org
cbaworks.org

Chicago Cook Workforce Partnership
69 W Washington Street
Suite 2860
Chicago, IL 60602
Marissa Lewis
mlewis@chicocookworks.org
(312) 603-0200
chicocookworks.org

Chicago Minority Supplier Development Council
216 W Jackson Boulevard
Suite 600 Chicago, IL 60606
Debra Jennings-Johnson
(312) 755-8880
info@ChicagoMSDC.org
chicagommsdc.org

Chicago Urban League
4510 S Michigan Ave, 3rd Floor
Chicago, IL 60653
Kelly Evans
(773) 451-3547
kevans@chiul.org
chiul.org

Chicago Women in Trades
2444 W 16th St
Chicago, IL 60608
Jayne Vellinga
(312) 942-1444
jvellinga@cwit2.org
chicagowomenintrades2.org

ConstructConnect
3825 Edwards Road, #800
Cincinnati, OH 45209
Amanda Beyer
(513) 458-5837, Extension 5108336
amanda.beyer@constructconnect.com
ConstructConnect.com

Construction Business Development Center at Prairie State College
202 S Halsted St
Chicago Heights, IL 60411
Cathy Svetanoff
(708) 709-3568
csvetanoff@prairiestate.edu
prairiestate.edu

Federation of Women Contractors
4210 W Irving Park Rd
Chicago, IL 60641
Jaemie Neely
(312) 360-1122
info@fwcchicago.com
fwcchicago.com

HIRE360 Chicago
2301 S Lake Shore Drive
Lakeside Center, Chicago, IL 60616
Deborah Whitaker
(312) 575-2500
dwhitaker@hire360chicago.com
bids@hire360chicago.com

Hispanic American Construction Industry Association
650 W Lake St, #415
Chicago, IL 60661
Ivette Trevino
(312) 575-0389
itrevino@haciaworks.org
haciaworks.org

Illinois Black Chamber of Commerce
411 Hamilton Blvd, #1404
Peoria, IL 61602
Larry Ivory & Kenyatta Fisher
(309) 740-4430
larryivory@illinoisblackchamber.org
kfisher@ibcc.org
illinoisblackchamber.org

Rainbow/PUSH Coalition
930 E 50th St
Chicago, IL 60615
John Mitchell
(773) 256-2766
jmitchell@rainbowpush.org
rainbowpush.org

South Shore Chamber, Inc.
1750 E 71st St
Chicago, IL 60649
Tonya Trice
(773) 955-9508
ttrice@southshorechamberinc.org
southshorechamberinc.org



U.S. Minority Contractors Association
1250 Grove Ave, #200
Barrington, IL 60010
Larry Bullock
(847) 852-5010
larry.bullock@usminoritycontractors.org
usminoritycontractors.org

Women's Business Development Center
8 S Michigan Ave, #400
Chicago, IL 60603
Donna Beasley
(312) 853-3477
dbeasley@wbdc.org
wbdc.org

Women Construction Owners & Executives
308 Circle Ave
Forest Park, IL 60130
Mary Kay Monaghan
(708) 366-1250
mkm@mkmservices.com
wcoeusa.org

TECH REVIEW MEETING

Date/Time

May 20, 2024 at 10:30 a.m.

(Immediately following this meeting)

SITE VISIT

None has been scheduled.

Notwithstanding

- Failure of the Bidders to become familiar with the Project shall not relieve or alter the Bidder's responsibility for completing the Work as required by the Contract Documents.

Procurement Details

REQUEST FOR INFORMATION (RFI'S)

Sole Point of Contact

James Borkman, Contract Officer

james.borkman@cityofchicago.org

Deadline

Current: May 31, 2024 by 4:00 p.m.

Addenda

None issued to date

Procurement Details

BID DUE DATE/TIME

Due Date/Time

June 5, 2024 at 11:00 a.m.

(Subject to Change via Addendum)

Virtual Meeting Details

NOTE: The Bid Opening will be streamed LIVE and will be RECORDED and AVAILABLE on our website for viewing on PBC's Home Page www.pbcchicago.com and on the Current Opportunity page for this project found here: <https://www.pbcchicago.com/opportunities/advertisement-for-bids-contract-c1603-wpastreetreconstructionmedillave/>

BID SUBMISSION REQUIREMENTS

Electronic Submission

- **One** complete copy of bid document
- Original Signatures ([blue ink](#)) or Digital Signature
- Include Bid Bond
- Include Master Bid Form (Master Bid Tab, TWO Schedule of Prices, Award Criteria sheet) in **EXCEL and PDF** format separately within email

NOTE: The pdf documents should be searchable PDF form and not a scanned copy.

- Email to: bids@pbcchicago.com **AND** james.borkman@cityofchicago.org

If Hardcopy Submission Needed

- *Bidders who are unable to submit their bids electronically may request instruction for submitting a “hard copy” of their bid in writing to the Contract Officer: James Borkman at james.borkman@cityofchiago.org*

Procurement Details

PRE-AWARD MEETING

Date/Time

Thursday, June 6, 2024 at 10:00 a.m. (Virtual)
(Subject to Change via Addendum)

NOTICE OF AWARD

Anticipated Schedule

- Anticipated release of the Notice of Award (NOA) is [June 2024](#) following the PBC Board of Commissioners Meeting
- Successful General Contractor will be required to provide compliant Certificate of Insurance and Payment and Performance Bond within 7 days of NOA issuance



**Book 1 & 2 Highlights
&
Compliance**

Highlights

BOOK 1 AND BOOK 2 HIGHLIGHTS

Budget, Staffing, and Additional Requirements

- Estimated Construction Budget (Book 1, Page 2) – \$2,300,000 - \$2,500,000
 - Mandatory Project Staffing (Book 1, Page 3)
 - Scheduling Software Requirements (Book 1, Page 4)
 - Liquidated Damages (Book 1, Page 4)
 - Prevailing Wage Rates (Book 1, Page 5 and Page 64)
-
- Contractor will be required to prepare a Phasing and Logistics Plan for review and approval by CDOT and PBC, prior to the mobilization and commencement of any Work.

Highlights

BOOK 1 AND BOOK 2 HIGHLIGHTS

Joint Venture Opportunities

- Schedule B – Joint Venture Affidavit
- (Book 1, Page 25)
 - ❖ JV Agreement
 - ❖ Certification Letter

SCHEDULE B - Joint Venture Affidavit (1 of 3)

This form is not required if all joint venturers are MBE/Non-MBE or WBE/Non-WBE firms. In such case, however, a written joint venture agreement among the MBE/Non-MBE or WBE/Non-WBE firms should be submitted. Each MBE/WBE joint venturer must also attach a copy of their current certification letter.

A. Name of joint venture _____

B. Address of joint venture _____

C. Phone number of joint venture _____

D. Identify the firms that comprise the joint venture

1. Describe the role(s) of the MBE/WBE firm(s) in the joint venture. (Note that a "clearly defined portion of work" must here be shown as under the responsibility of the MBE/WBE firm.)

2. Describe very briefly the experience and business qualifications of each non-MBE/WBE joint venturer.

E. Nature of joint venture's business

F. Provide a copy of the joint venture agreement.

G. Ownership: What percentage of the joint venture is claimed to be owned by MBE/WBE? _____%

H. Specify as to:

1. Profit and loss sharing _____%

2. Capital contributions, including equipment _____%

3. Other applicable ownership interests, including ownership options or other agreements which restrict ownership or control.

Highlights

THE BID FORM – MASTER BID TAB

Project Name: Chicago Department of Transportation Works Progress Administration ("WPA")
 Street Reconstruction South Central Park Avenue and East 91st Street

Contract No. C1608

Project Nos. 22830 and 22682

FIRM NAME: _____

S. Central Park Avenue	LINE	DESCRIPTION	AMOUNT	
	22830 - South Central Park Avenue			
	1	Base Work Only	\$ -	
	2	Commission's Contract Contingency	\$ 150,000.00	
	3	Sitework Allowance	\$ 50,000.00	
4	TOTAL BASE BID	\$ 200,000.00		
Accepted by the Commission			<input type="checkbox"/>	

E. 91st Street	LINE	DESCRIPTION	AMOUNT	
	22682 - East 91st Street			
	5	Base Work Only	\$ -	
	6	Commission's Contract Contingency	\$ 225,000.00	
	7	Sitework Allowance	\$ 50,000.00	
8	TOTAL BASE BID	\$ 275,000.00		
Accepted by the Commission			<input type="checkbox"/>	

LINE	DESCRIPTION	TOTAL AMOUNTS
29	GRAND TOTAL BASE BID - ALL STREETS	\$ 475,000.00
30	GRAND TOTAL AWARD CRITERIA FIGURE - ALL STREETS	\$ 475,000.00

SURETY INFORMATION
 (Provide Legal Name and address of Surety)

Name: _____

Address: _____

BIDDER'S INFORMATION

Firm Name: _____

Date: _____

NOTES/INSTRUCTIONS



Highlights

THE BID FORM - TABS

NOTES/INSTRUCTIONS

Prior to submitting your bid electronically, please do the following:

1. Ensure ALL SEVEN (7) Schedule of Prices Worksheets are Complete.
2. Ensure Award Criteria Worksheet is Complete.
3. Ensure Surety Information section, and Bidder's Information section have been populated.
4. Save the file.
5. Convert the file to PDF.
6. Include copy of the Bid Form and Schedule of Prices within the scanned copy of the bid.
7. Attach the PDF version, along with the scanned copy of the bid.

<	>	Master Bid Tab	Award Criteria Figure	22830 S. Central Park	22682 E. 91st
---	---	-----------------------	-----------------------	-----------------------	---------------



Each Location has a separate tab (2 TOTAL)

Enter your unit pricing for EACH LOCATION

The Master Bid Form will automatically TOTAL

Highlights

THE BID FORM – SCHEDULE OF PRICES

SCHEDULE OF PRICES
 CHICAGO DEPARTMENT OF TRANSPORTATION WORKS PROGRESS ADMINISTRATION ("WPA") STREET RECONSTRUCTION
 SOUTH CENTRAL PARK AVENUE
 LOCATION: FROM WEST 75th PLACE to WEST 75th STREET - Ward 18
 PBC PROJECT NO.: 22830
 CDOT PROJECT NO.: B-2-830 – PBC CONTRACT C1608

Bidder's pricing for each line item should carry its share of the costs of work, plus its share of overhead and profit. Bidders should avoid nominal pricing for some lines and enhanced pricing for other lines.

Bids that the PBC considers to be materially unbalanced will be rejected.

Line	Code Number	Description	Unit	Estimated Quantity	Unit Price	Cost
1	20200100	EARTH EXCAVATION	CU YD	820		\$0.00
2	*****	TREE REMOVAL (1 TO 6 IN DIAMETER)	UNIT	0		\$0.00
3	20100110	TREE REMOVAL (6 TO 15 IN DIAMETER)	UNIT	24		\$0.00
4	*****	TREE PROTECTION	EACH	5		\$0.00
5	20800150	TRENCH BACKFILL	CU YD	215		\$0.00
6	21101615	TOPSOIL FURNISH AND PLACE, 4-INCH	SQ YD	675		\$0.00
7	25200110	SODDING, SALT TOLERANT	SQ YD	675		\$0.00
8	*****	TREE PLANTING, 2-1/2 INCH TO 3-INCH B&B	EACH	2		\$0.00
9	CDOT2510010	SHREDDED HARDWOOD BARK MULCH	SQ YD	12		\$0.00
10	31101100	SUB-BASE GRANULAR MATERIAL, TYPE B, 6-INCH	CU YD	215		\$0.00
11	35300200	PORTLAND CEMENT CONCRETE BASE COURSE, 7-INCH	SQ YD	1078		\$0.00
12	40600290	BITUMINOUS MATERIALS (TACK COAT)	POUND	764		\$0.00
13	40600525	LEVELING BINDER (HAND METHOD), N50	TON	2		\$0.00
14	40600635	LEVELING BINDER (MACHINE METHOD), N50 1-1/2 INCH	TON	92		\$0.00
15	40604060	HOT-MIX ASPHALT SURFACE COURSE, MIX "D", N50, 2-INCH	TON	125		\$0.00
16	80173	BITUMINOUS COST ADJUSTMENT	CAL MONTH	6		\$0.00
17	*****	PORTLAND CEMENT CONCRETE SIDEWALK, 8-INCH	SQ FT	368		\$0.00
18	CDOT4240010	PORTLAND CEMENT CONCRETE SIDEWALK, 5-INCH	SQ FT	362		\$0.00
19	CDOT4240030	PORTLAND CEMENT CONCRETE ADA CURB RAMP, 5-INCH	SQ FT	222		\$0.00
20	CDOT4240040	PORTLAND CEMENT CONCRETE ADA CURB RAMP, 8-INCH	SQ FT	72		\$0.00
21	CDOT4240055	LINEAR DETECTABLE WARNING TILES (CAST IRON)	SQ FT	24		\$0.00

**Enter your
unit pricing
HERE**

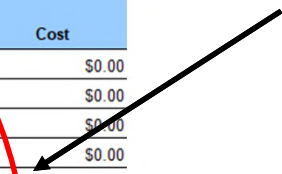

Highlights

THE BID FORM – MASTER BID TAB

Project Name: Chicago Department of Transportation Works Progress Administration ("WPA")
 Street Reconstruction South Central Park Avenue and East 91st Street

Contract No. C1608

Project Nos. 22830 and 22682

FIRM NAME: _____

S. Central Park Avenue	LINE	DESCRIPTION	AMOUNT
		22830 - South Central Park Avenue	
	1	Base Work Only	\$ -
	2	Commission's Contract Contingency	\$ 150,000.00
	3	Sitework Allowance	\$ 50,000.00
4	TOTAL BASE BID	\$ 200,000.00	
Accepted by the Commission			<input type="checkbox"/>

E. 91st Street	LINE	DESCRIPTION	AMOUNT
		22682 - East 91st Street	
	5	Base Work Only	\$ -
	6	Commission's Contract Contingency	\$ 225,000.00
	7	Sitework Allowance	\$ 50,000.00
8	TOTAL BASE BID	\$ 275,000.00	
Accepted by the Commission			<input type="checkbox"/>

LINE	DESCRIPTION	TOTAL AMOUNTS
29	GRAND TOTAL BASE BID - ALL STREETS	\$ 475,000.00
30	GRAND TOTAL AWARD CRITERIA FIGURE - ALL STREETS	\$ 475,000.00

SURETY INFORMATION
 (Provide Legal Name and address of Surety)

Name: _____

Address: _____

BIDDER'S INFORMATION

Firm Name: _____

Date: _____

NOTES/INSTRUCTIONS

The **TOTAL** from the Unit Pricing Sheet will automatically populate **HERE**

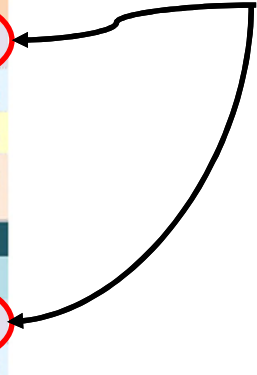

Highlights

THE BID FORM – MASTER BID TAB TOTAL & FIRM INFO

LINE	DESCRIPTION	TOTAL AMOUNTS
29	GRAND TOTAL BASE BID - ALL STREETS	\$ 475,000.00
30	GRAND TOTAL AWARD CRITERIA FIGURE - ALL STREETS	\$ 475,000.00

SURETY INFORMATION (Provide Legal Name and address of Surety)	
Name:	
Address:	
BIDDER'S INFORMATION	
Firm Name:	
Date:	
NOTES/INSTRUCTIONS	

Enter your Surety & Firm Information HERE

The TOTAL from ALL streets/avenues will automatically populate HERE

Highlights

PROJECT NAME: Chicago Department of Transportation Works Progress Administration ("WPA") Street Reconstruction South Central Park Avenue and East 91st Street
 CONTRACT NO: C1608
 PROJECT NO: 22830 and 22682

AWARD CRITERIA FIGURE FORMULA (For Electronic Submission)

	FORMULA
Line 1. (Based on Grand Total Base Bid)	\$475,000.00
Line 2. Minority Journeyman (Maximum figure 0.70)	
Line 3. Multiply Line 2 by Line 1 by 0.04	\$0.00
	\$475,000.00
Line 4. Minority Apprentice (Maximum figure 0.70)	
Line 5. Multiply Line 4 by Line 1 by 0.03	\$0.00
	\$475,000.00
Line 6. Minority Laborer (Maximum figure 0.70)	
Line 7. Multiply Line 6 by Line 1 by 0.01	\$0.00
	\$475,000.00
Line 8. Female Journeyman (Maximum figure 0.15)	
Line 9. Multiply Line 8 by Line 1 by 0.04	\$0.00
	\$475,000.00
Line 10. Female Apprentice (Maximum figure 0.15)	
Line 11. Multiply Line 10 by Line 1 by 0.03	\$0.00
	\$475,000.00
Line 12. Female Laborer (Maximum figure 0.15)	
Line 13. Multiply Line 12 by Line 1 by 0.01	\$0.00
	\$475,000.00
Line 14. Total of Lines 3, 5, 7, 9, 11, and 13	\$0.00
Line 15. Total Award Criteria	\$475,000.00
TOTAL AWARD CRITERIA (Line 15)	\$475,000.00

Page 1

Accepted by the Commission

BIDDER'S INFORMATION

Firm Name: _____
 Date: _____

AWARD CRITERIA FIGURE



Compliance

MBE/WBE PARTICIPATION

MBE/WBE Goal

26%, MBE

6%, WBE

MBE/WBE Certifications

- City of Chicago
- Cook County

MBE/WBE Special Conditions

Book 2, Article 23

Compliance: Certification

PBC ensures that only certified and experienced firms perform the required services.

MBE or WBE firms must be certified with the City of Chicago and/or Cook County to be counted as an MBE/WBE firm by the PBC.



BOOK 1 AND BOOK 2 HIGHLIGHTS

Award Criteria Figure

Maximum **70%**

Minority Journeyworker,
Apprentice, and;
Laborer

Maximum **15%**

Female Journeyworker,
Apprentice, and;
Laborer

City Residency & Community Hiring

PBC encourages the creation of career opportunities for residents of a project's surrounding community areas, both in the construction trades as well as skilled and unskilled workers.

- ☑ **Community hiring goal:** at least **7.5%** of project labor performed by community residents
- ☑ **City residency goal:** at least **50%** of project labor performed by residents of the city of Chicago

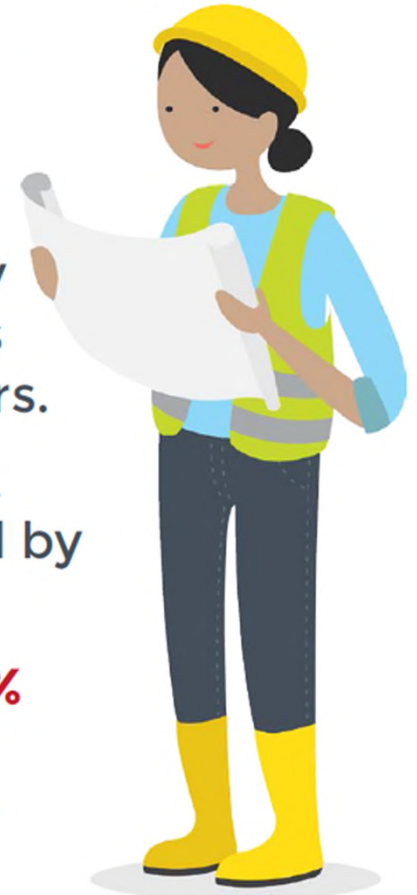

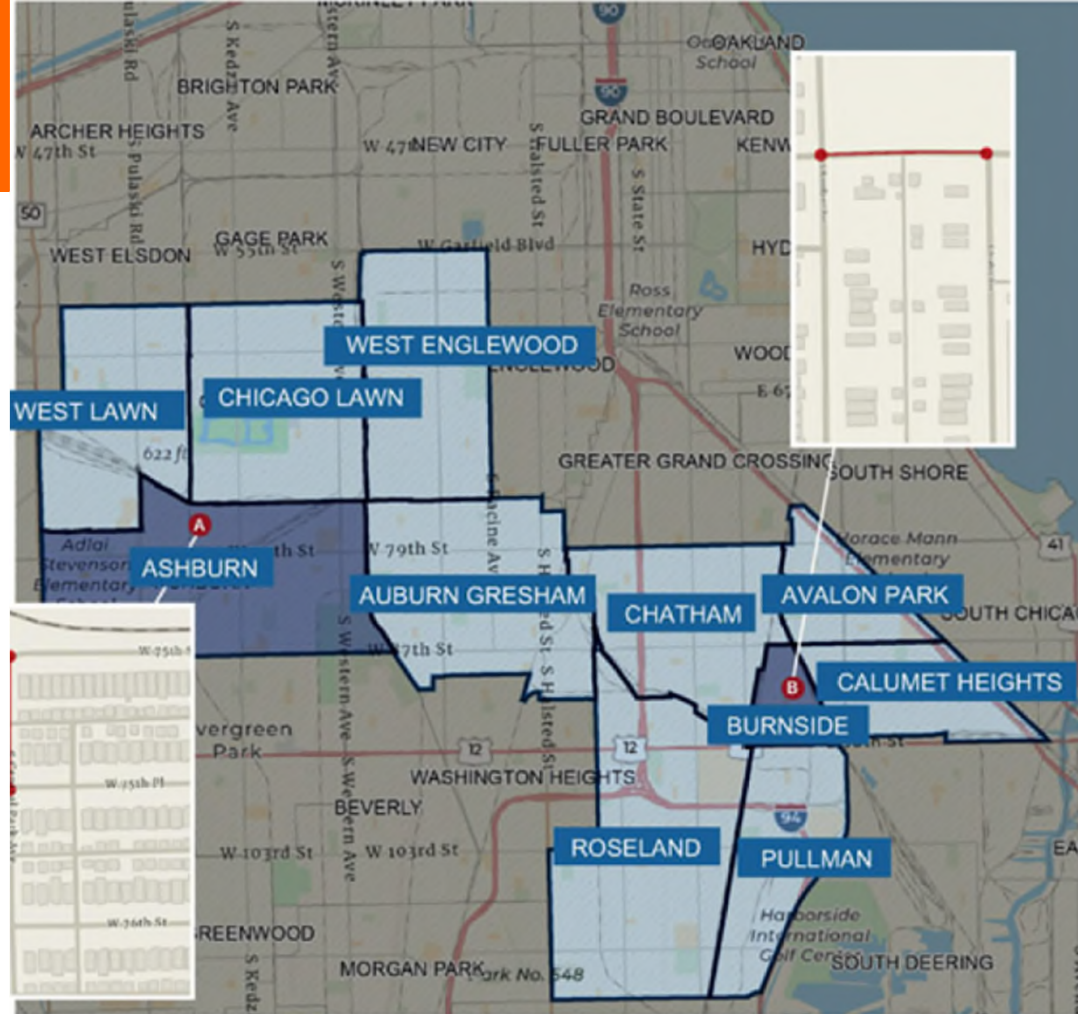

CDOT WPA Street Reconstruction South Central Park Avenue | East 91st Street

- Project location
- A S. Central Park - 75th St. to 75th Pl.
- B E. 91st - Woodlawn to Avalon
- Project Area
- Community Areas

Community Hiring
MAP

MBE/WBE COMPLIANCE

Documentation and Monitoring

- B2Gnow: MBE/WBE Compliance monitoring
- Established Business, Manufacturers, Suppliers, and Brokers
- Schedule D
- Schedule C

Compliance

MBE/WBE COMPLIANCE

Schedule D

PUBLIC BUILDING COMMISSION OF CHICAGO

SCHEDULE D - Affidavit of General Contractor Regarding MBE/WBE Participation (1 of 2)

Name of Project: _____

STATE OF ILLINOIS }
 }SS
COUNTY OF COOK }

In connection with the above-captioned contract, I HEREBY DECLARE AND AFFIRM that I am the

_____ Title and duly authorized representative of

_____ Name of General Contractor whose address is

_____ in the City of _____, State of _____ and that I have personally reviewed the material and facts submitted with the attached Schedules of MBE/WBE participation in the above-referenced Contract, including Schedule C and Schedule B (if applicable), and the following is a statement of the extent to which MBE/WBE firms will participate in this Contract if awarded to this firm as the Contractor for the Project.

Name of MBE/WBE Contractor	Type of Work to be Done in Accordance with Schedule C	Dollar Credit Toward MBE/WBE Goals	
		MBE	WBE
		\$	\$
		\$	\$
		\$	\$
		\$	\$
		\$	\$
		\$	\$
		\$	\$
		\$	\$
Total Net MBE/WBE Credit		\$	\$
Percent of Total Base Bid		%	%

The General Contractor may count toward its MBE/WBE goal a portion of the total dollar value of a contract with a joint venture equal to the percentage of the ownership and control of the MBE/WBE partner.

PUBLIC BUILDING COMMISSION OF CHICAGO

SCHEDULE D - Affidavit of General Contractor Regarding MBE/WBE Participation (2 of 2)

The Undersigned will enter into a formal agreement for the above work with the above-referenced MBE/WBE firms, conditioned upon performance as Contractor of a Contract with the Commission, and will do so within five (5) business days of receipt of a notice of Contract award from the Commission.

Additionally, the Undersigned certifies to the best of its knowledge and belief that it, its principals and any subcontractors used in the performance of this contract, meet the Agency requirements and have not violated any City or Sister Agency policy, codes, state, federal or local laws, rules or regulations and have not been subject to any debarment, suspension or other disciplinary action by any government agency. Additionally, if at any time the Contractor becomes aware of such information, it must immediately disclose it to the Commission.

BY:

_____ Name of Contractor (Print)

_____ Signature

_____ Date

_____ Name (Print)

_____ Phone

IF APPLICABLE:

BY:

_____ Joint Venture Partner (Print)

_____ Signature

_____ Date

_____ Name (Print)

_____ Phone/FAX

MBE ____ WBE ____ Non-MBE/WBE ____



Compliance

MBE/WBE COMPLIANCE

Schedule C

PUBLIC BUILDING COMMISSION OF CHICAGO

SCHEDULE C - Letter of Intent from MBE/WBE (1 of 2) To Perform As Subcontractor, Subconsultant, and/or Material Supplier

Name of Project: _____

Project Number: _____

FROM:

_____ MBE _____ WBE _____
(Name of MBE or WBE)

TO:

_____ and Public Building Commission of Chicago
(Name of Bidder)

The undersigned intends to perform work in connection with the above-referenced project as (check one):

_____ a Sole Proprietor _____ a Corporation
_____ a Partnership _____ a Joint Venture

The MBE/WBE status of the undersigned is confirmed by the attached Letter of Certification, dated _____, In addition, in the case where the undersigned is a Joint Venture with a non-MBE/WBE firm, a Schedule B, Joint Venture Affidavit, is provided.

The undersigned is prepared to provide the following described services or supply the following described goods in connection with the above-named project.

The above-described services or goods are offered for the following price, with terms of payment as stipulated in the Contract Documents.

PUBLIC BUILDING COMMISSION OF CHICAGO

SCHEDULE C - Letter of Intent from MBE/WBE (2 of 2) To Perform As Subcontractor, Subconsultant, and/or Material Supplier

PARTIAL PAY ITEMS

For any of the above items that are partial pay items, specifically describe the work and subcontract dollar amount:

If more space is needed to fully describe the MBE/WBE firm's proposed scope of work and/or payment schedule, attach additional sheet(s).

SUB-SUBCONTRACTING LEVELS*

_____ % of the dollar value of the MBE/WBE subcontract will be sublet to non-MBE/WBE contractors.
_____ % of the dollar value of the MBE/WBE subcontract will be sublet to MBE/WBE contractors.

***If MBE/WBE subcontracting will not be sub-subcontracting any of the work described in this Schedule, a zero (0) must be filled in each blank above. If more than 10% percent of the value of the MBE/WBE subcontractor's scope of work will be sublet, a brief explanation and description of the work to be sublet must be provided.**

The Undersigned (Contractor) will enter into a formal agreement for the above work with the Bidder, conditioned upon its execution of a contract with the Public Building Commission of Chicago, and will do so within five (5) working days of receipt of a notice of Contract award from the Commission.

Additionally, the Undersigned certifies to the best of its knowledge and belief that it, its principals and any subcontractors used in the performance of this contract, meet the Agency requirements and have not violated any City or Sister Agency policy, codes, state, federal or local laws, rules or regulations and have not been subject to any debarment, suspension or other disciplinary action by any government agency. Additionally, if at any time the Contractor becomes aware of such information, it must immediately disclose it to the Commission.

BY:

Name of MBE/WBE Firm (Print)

Date

Phone

IF APPLICABLE:
BY:

Joint Venture Partner (Print)

Date

Phone

Signature

Name (Print)

Signature

Name (Print)

MBE ___ WBE ___ Non-MBE/WBE ___

Highlights

BOOK 1 AND BOOK 2 HIGHLIGHTS

Basis of Award (Book 1, Page 8)

- Award will be made to the Bidder submitting the **Grand Total Award Criteria Figure** (Line 30 of Bid Form) whose corresponding Grand Total Base Bid (Line 29 of Bid Form) is within the Available Funds for each project and is otherwise responsive to all requirements of the Contract Documents.
- Firms are required to fill out the entire BID FORM to be considered responsive.
- The Commission reserves the right to reject any and all bids wherever such rejection is in the best interest of the Commission.
- Bids that the PBC considers to be materially unbalanced will be rejected.

PBC CONTACT

James Borkman

james.borkman@cityofchicago.org



Technical Review

Project Overview

Project Locations

- **E 91st St – S Woodlawn Ave to S Avalon Ave**
- **S Central Park Ave – W 75th Pl to W 75th St**

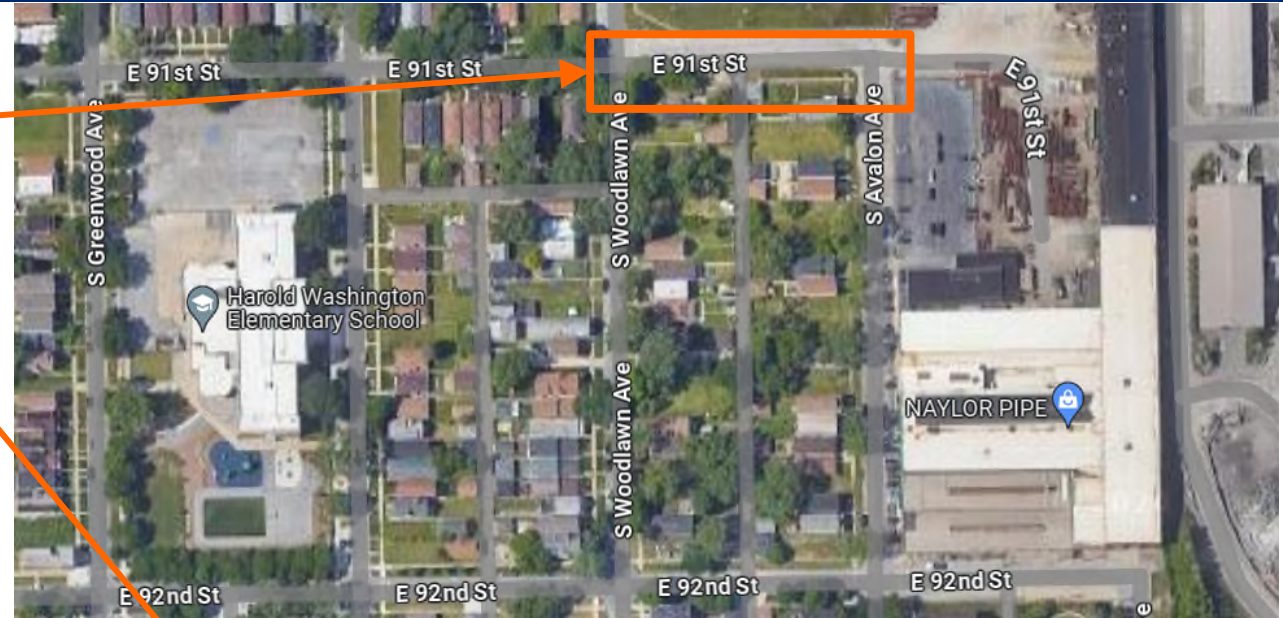

Project Overview

- Existing Conditions
- Proposed Work



Project Overview

Project Locations

- **E 91st St – S Woodlawn Ave to S Avalon Ave**

▪ Existing Conditions

- No curb and gutter
- Existing Driveway at Avalon and 91st (Naylor Pipe Company)
- Existing alley apron
- 42' roadway width
- Sidewalk on southside in poor condition

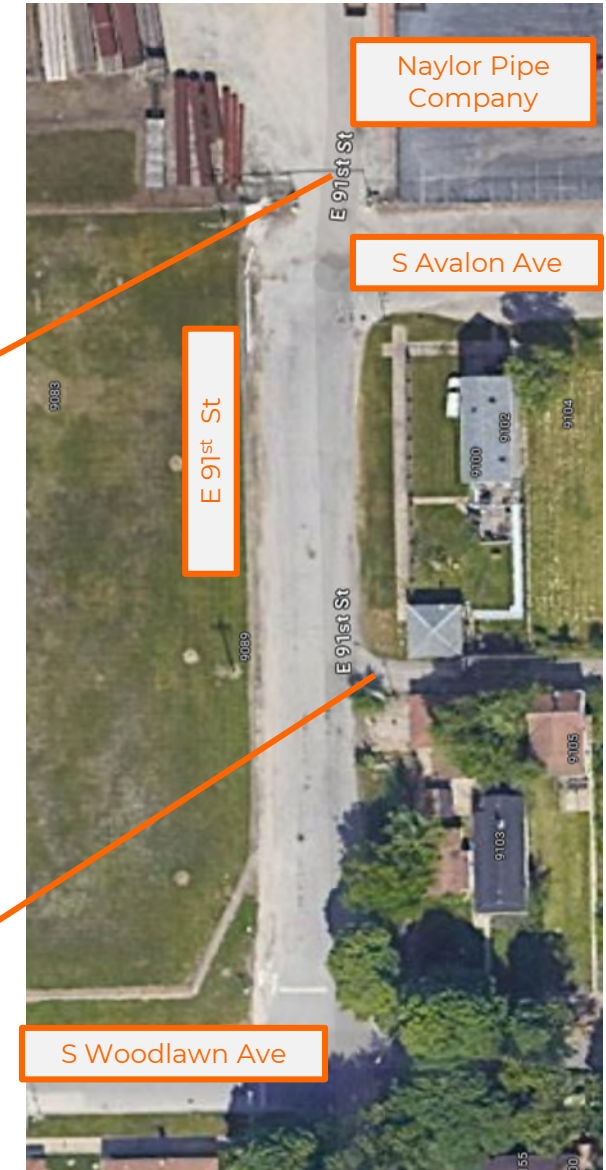

Project Overview

▪ Existing Conditions

- Proposed Work

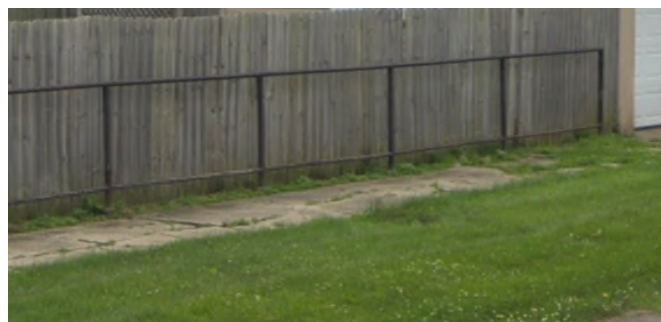

Project Overview

Project Locations

- **E 91st St – S Woodlawn Ave to S Avalon Ave**

Existing Conditions

- Environmental report available in Book 3, Appendix C.
- Landfill as Non-Special Waste (NSW).

TABLE 7 – Soil Disposal Description Summary

Soil Boring ID	Soil Interval	Sample Classification	Parameter(s) Exceeding MAC(s)	Eligible for CCDD or USFO Disposal?	Soil Disposal Classification (Max Excavation Depth) ¹
L-1	0-4'	669.05(a)(5)	Benz(a)anthracene, Benzo(a)pyrene, Benzo(b)fluoranthene, Dibenz(a,h)anthracene, Indeno(1,2,3-cd)pyrene; Arsenic	No: 0-4'	0-8': Landfill as Non-Special Waste (NSW)
	4-8'	669.05(a)(5)	Arsenic	No: 4-8'	
L-2	0-4'	669.05(a)(2)	Benzo(a)pyrene	Yes: 0-4'	0-4': Landfill as NSW (Recommended)
	4-8'	669.05(a)(5)	Arsenic	No: 4-8'	4-8': Landfill as NSW
L-3	0-4'	669.05(a)(5)	Glass, Metal; Benzo(a)pyrene, Dibenz(a,h)anthracene; Arsenic, Lead	No: 0-4'	0-8': Landfill as Non-Special Waste (NSW)
	4-8'	669.05(a)(5)	Arsenic	No: 4-8'	

Project Overview

Existing Conditions

- Proposed Work



Project Overview

Project Locations

- **E 91st St – S Woodlawn Ave to S Avalon Ave**

Proposed Work

- Street Lights and foundations
- 299' of 36" RCP sewer main, 38' of 8" ESVCP,
- 2 Catch Basins, 2 Manholes
- 368' of 8" water main
- Full depth pavement
- Parkway sod and trees

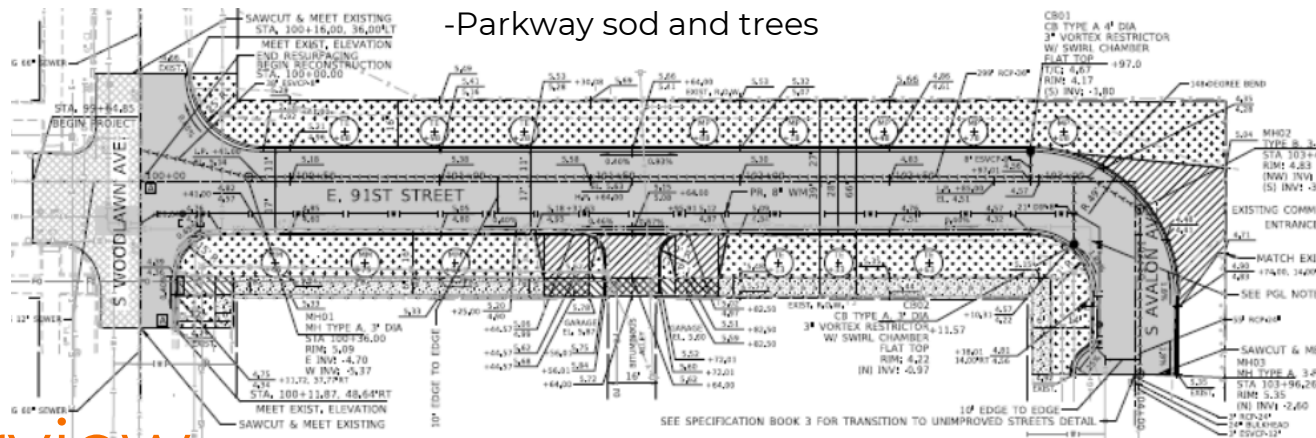
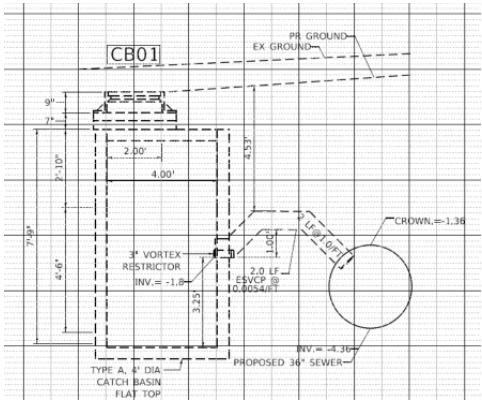

Project Overview

- Existing Conditions
- Proposed Work



Project Overview

Project Locations

- **E 91st St – S Woodlawn Ave to S Avalon Ave**

Proposed Work

- ADA Ramp
- Driveways
- Alley Apron

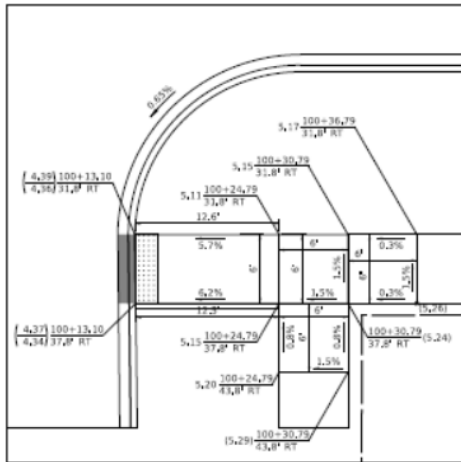

SE CORNER 91ST ST. & WOODLAWN AVE.

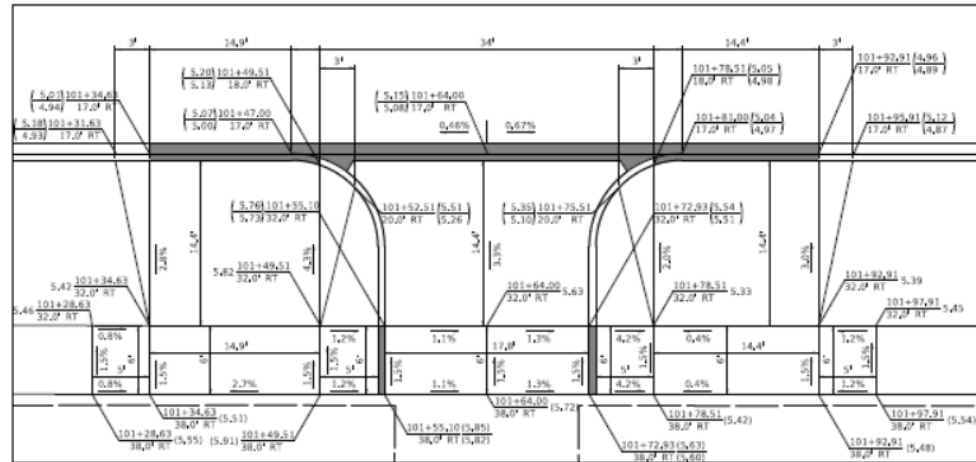

ALLEY & DRIVEWAYS ALONG S. SIDE OF 91ST ST.

Project Overview

- Existing Conditions
- Proposed Work

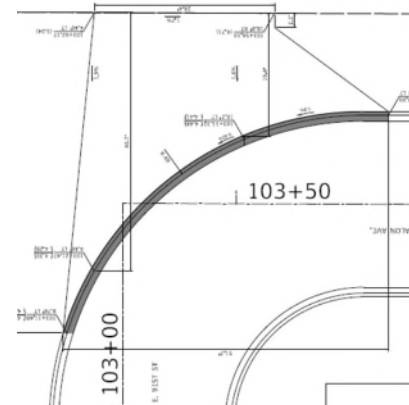

Project Overview

Project Locations

- **E 91st St – S Woodlawn Ave to S Avalon Ave**

Proposed Work

- MOT plan to keep access for Naylor Pipe Company during construction.
- 3 Stages

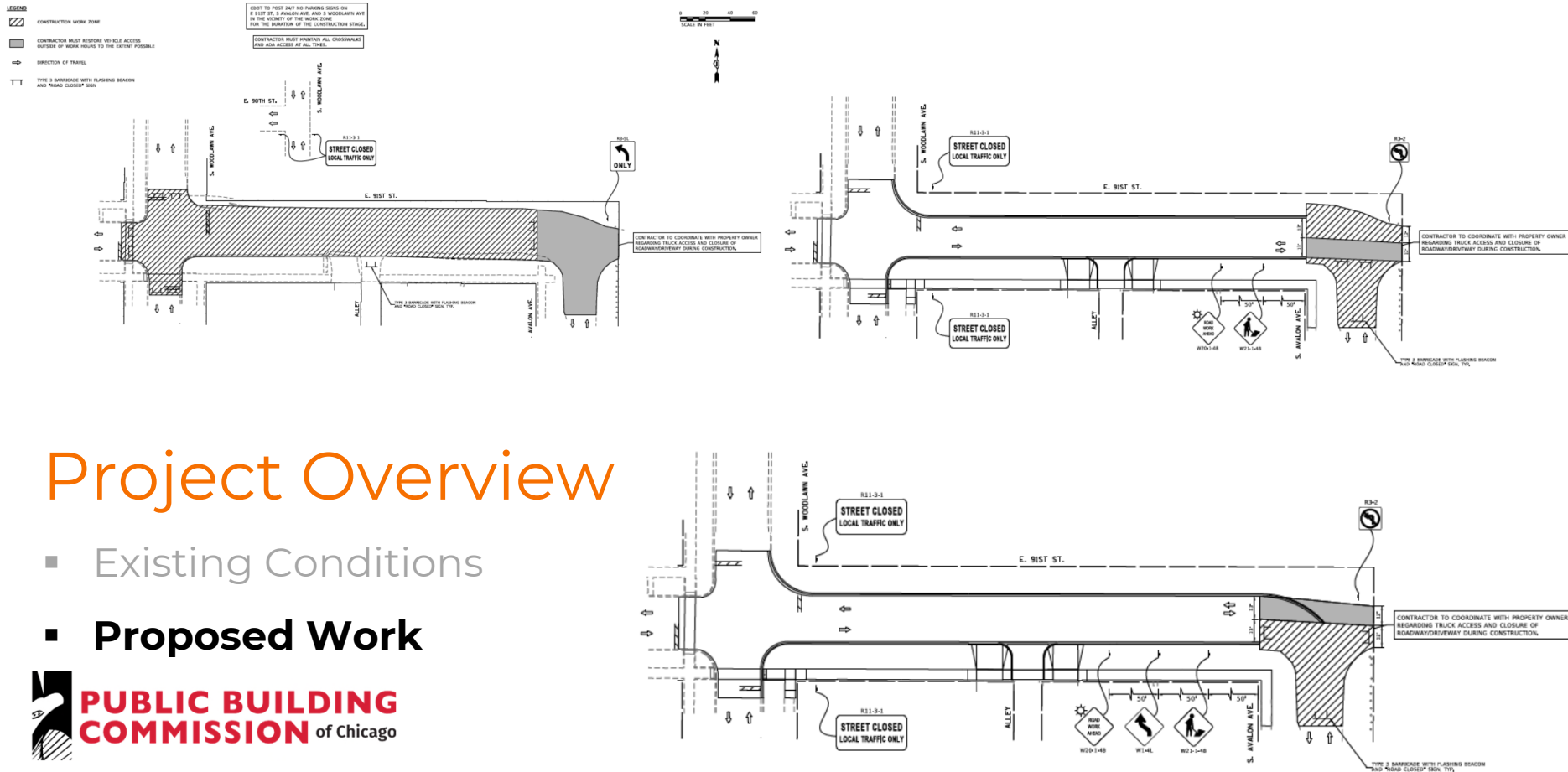

Project Overview

- Existing Conditions
- Proposed Work



Project Overview

Project Locations

- E 91st St – S Woodlawn Ave to S Avalon Ave
- **S Central Park Ave – W 75th Pl to W 75th St**



Existing Conditions

- Existing Street lights located in ROW
- Pavement in poor condition
- No curb and gutter
- No catch basins
- Adjacent to railroad

Project Overview

- **Existing Conditions**
- Proposed Work



Project Overview

Project Locations

- E 91st St – S Woodlawn Ave to S Avalon Ave
- **S Central Park Ave – W 75th Pl to W 75th St**

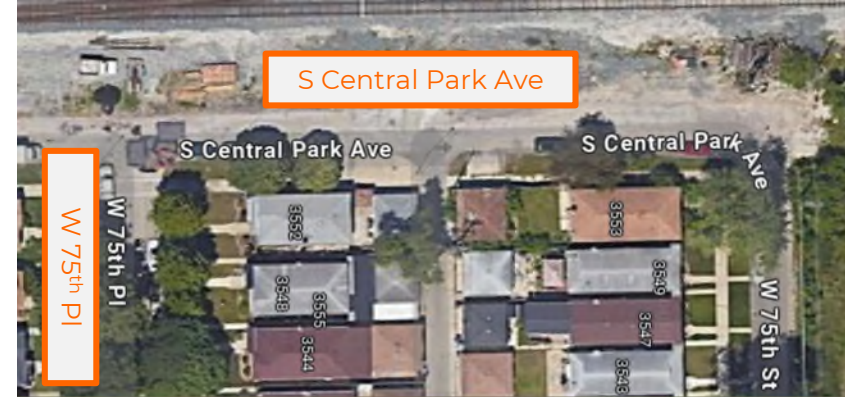

TABLE 8 – Soil Disposal Description Summary

Soil Boring ID	Soil Interval	Sample Classification	Parameter(s) Exceeding MAC(s)	Eligible for CCDD or USFO Disposal?	Soil Disposal Classification (Max Excavation Depth) ¹
A-1	0-4'	669.05(a)(5)	Arsenic; Debris: Slag and Glass; pH	No: 0-4'	0-4': Landfill as Non-Special Waste (NSW)
	4-8'	Unrestricted ²	None	Yes: 4-8'	4-8': CCDD (Unrestricted)
A-2	0-4'	669.05(a)(5)	Debris: Wood and Slag	No: 0-4'	Full depth: Landfill as NSW
	4-8'	669.05(a)(5)	Arsenic	No: 4-8'	
A-3	0-4'	Unrestricted ²	None	Yes: 0-4'	0-4': CCDD (Unrestricted)
	4-8'	669.05(a)(3)	Benzo(a)pyrene / Dibenzo(a,h)anthracene	Yes: 4-8'	4-8': CCDD (Within MSA Counties Including Chicago)

Existing Conditions

- Environmental report available in Book 3, Appendix B.
- Both CCDD Eligible and Landfill as Non-Special Waste (NSW).



Project Overview

- **Existing Conditions**
- Proposed Work

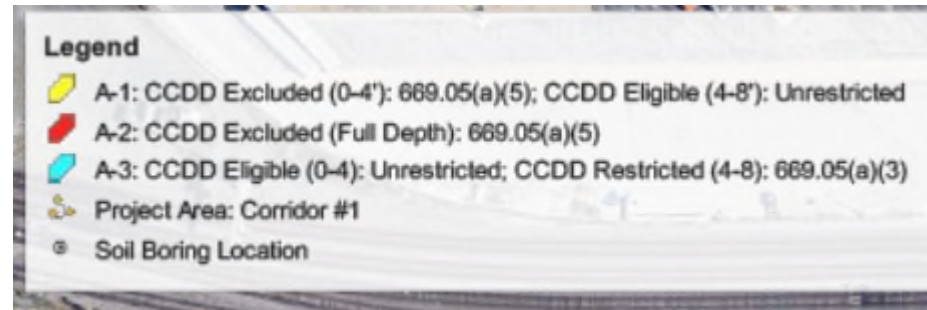

Project Overview

Project Locations

- E 91st St – S Woodlawn Ave to S Avalon Ave
- **S Central Park Ave – W 75th Pl to W 75th St**

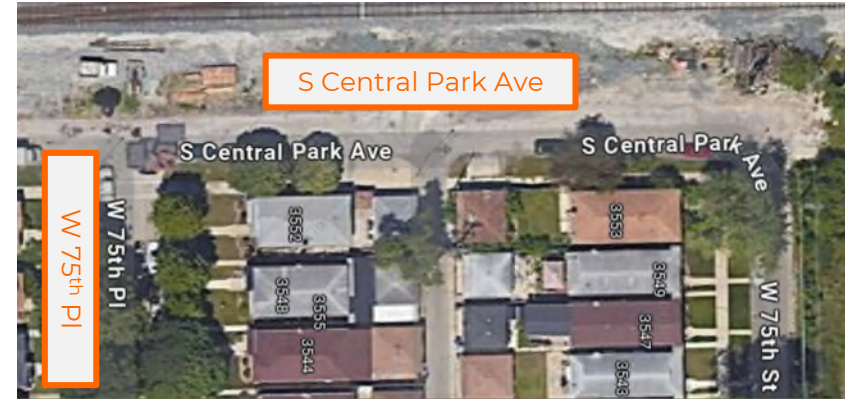
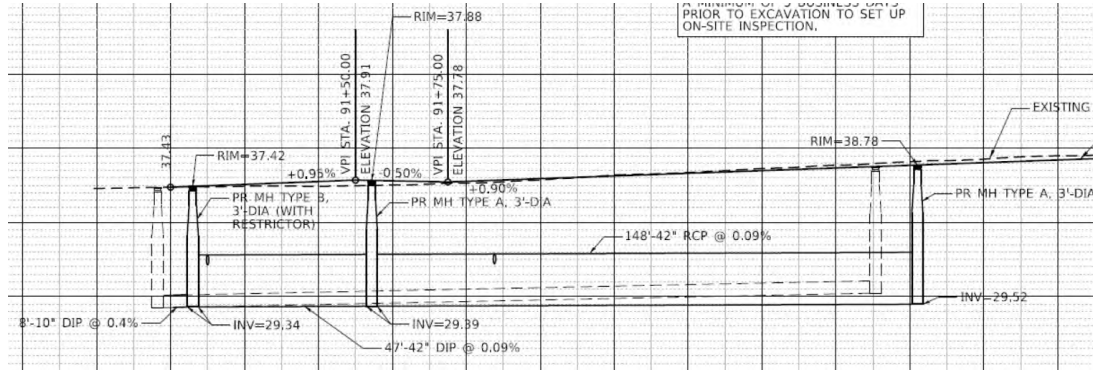

Proposed Work

- Street Lights and foundations
- 195' of 42" RCP/DIP storm sewer, 8' of 10" ESVCP,
- 2 Catch Basins, 3 Manholes
- Full depth pavement
- Parkway sod and trees

Project Overview

- Existing Conditions
- **Proposed Work**

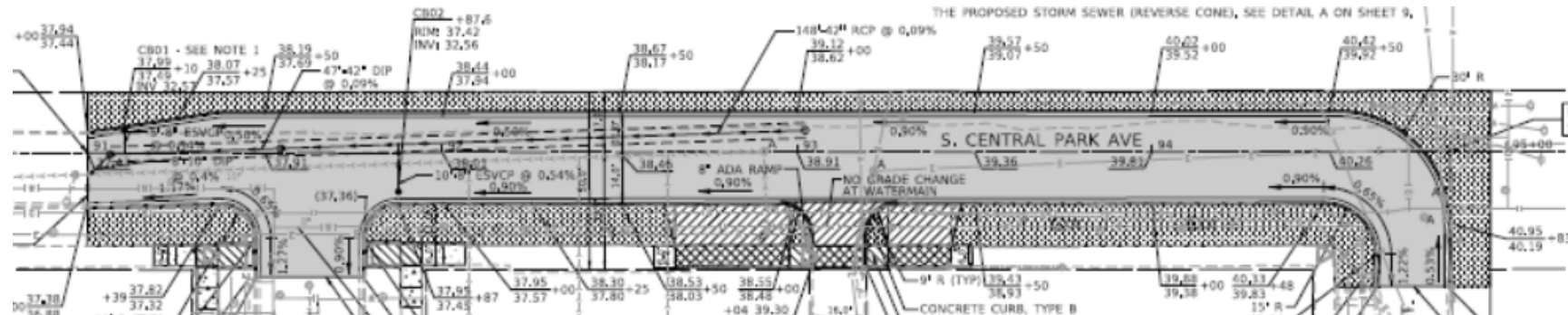

Project Overview

Project Locations

- E 91st St – S Woodlawn Ave to S Avalon Ave
- **S Central Park Ave – W 75th Pl to W 75th St**

St

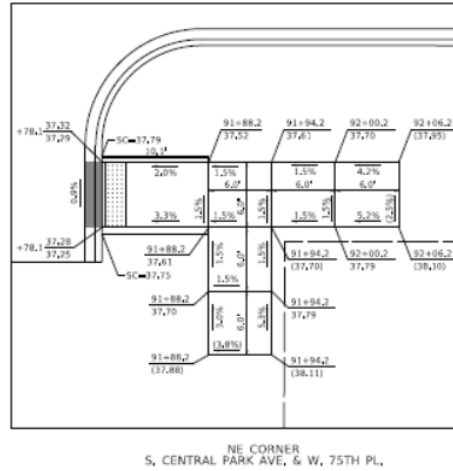
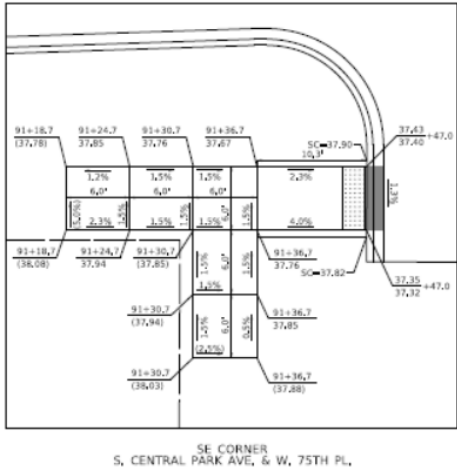

Proposed Work

- ADA Ramps
- Driveways
- Alley Apron

Project Overview

- Existing Conditions
- **Proposed Work**

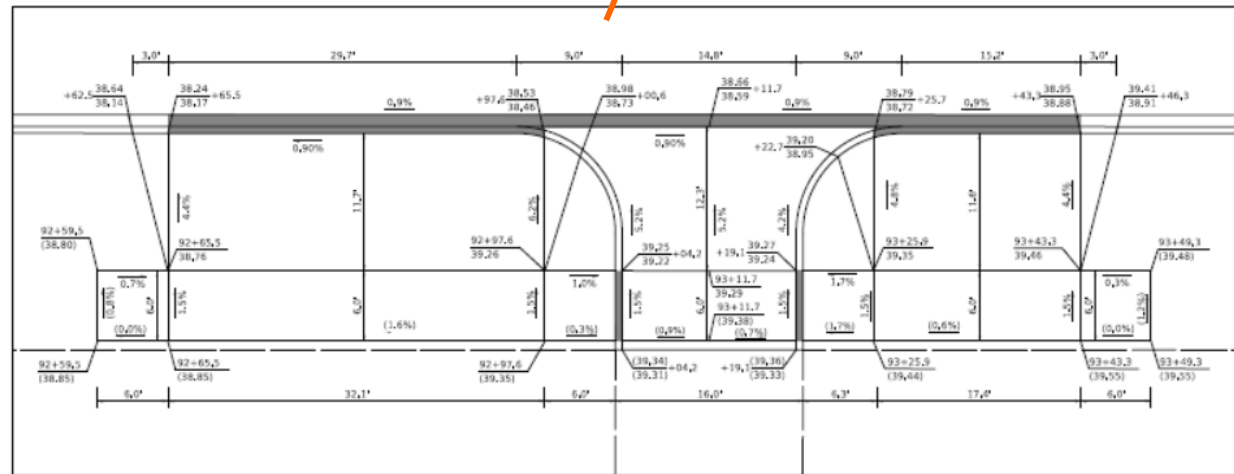



Q & A